

SkeleCore ETS™ External Tensioning System

Built for large spaces. Engineered to replace metal.

SkeleCore ETS is a structural fabric duct system designed for very large diameters where traditional metal ductwork has been the only option.

It is an externally supported tensioning system that maintains full shape and consistent airflow at extreme scale without the weight and complexity of metal.

WHY SKELECORE ETS

Engineered for Large-Scale Performance

- Maintains full shape at very large diameters
- Handles up to 200,000 CFM
- Delivers consistent, predictable air distribution

Replaces Traditional Metal Duct

- Lighter weight with fewer structural requirements
- Panelized fabric with external suspension requires fewer lifts and less equipment
- Simplified installation and handling improve jobsite safety and reduces installation time by up to 50% vs. metal systems

Built for Long-Term Reliability

- Structural framework designed for large-scale stability
- Reduces system stress and movement

HOW IT WORKS

External Structural Framework

ETS uses an external framework to support and tension the fabric from the outside.

- Structural rings mounted outside the fabric
- Load is transferred directly to the building structure
- Fabric is decoupled from the metal inlet, reducing stress on connections

**ENGINEERED
SUPPORT.
PROVEN
PERFORMANCE.**
Professional design
and installation
support for confidence
at every stage.



0% Deflation. Up to 156" Diameter. Built for Big Air.

IDEAL APPLICATIONS



Convention Centers



Aircraft Hangars



Stadiums & Arenas



High Volume Open Environments



Large Industrial Facilities

SPECIFICATIONS AT A GLANCE

- **Diameter Range:** 90" to 156"
- **Airflow Volume:** Up to 200,000 CFM
- **Deflation:** 0%
- **Fabric Installation:** Panelized system
- **Framework:** External structural ring system
- **Installation:** Modular components simplified handling
- **Warranty:** Up to 20 years

What is SkeleCore™?

SkeleCore is DuctSox's engineered tensioning system that adds structure to fabric duct.

Rather than relying on air pressure for shape retention, the SkeleCore™ family of products reduces or eliminates fabric deflation, improving appearance while supporting long-term system performance.

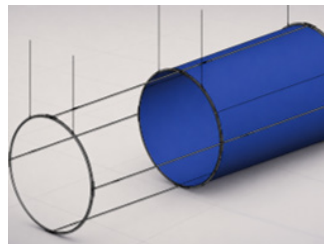
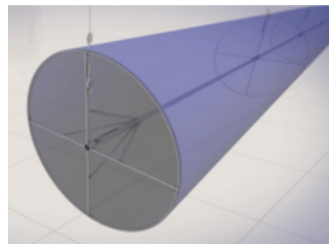
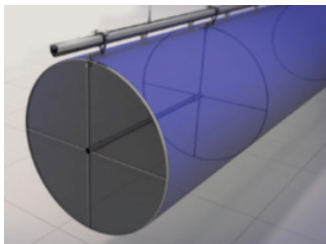

PT

SkeleCore Pull-Tight™ *Simple and Straight Runs*

- ✓ Entry-level tensioned system
- ✓ Best for small, simple layouts
- ✓ Improves appearance vs. basic support

FTS

SkeleCore FTS™ *Full Performance Control*

- ✓ Full tensioning (length + circumference)
- ✓ Eliminates sag, noise, and movement
- ✓ Handles diameters up to 100 in (2540 mm) with confidence

ETS

SkeleCore ETS™ *Built for Large-Scale Systems*

- ✓ Extends fabric into ultra-large diameters
- ✓ Replaces metal in high-bay applications
- ✓ Engineered for stability and performance in oversized systems

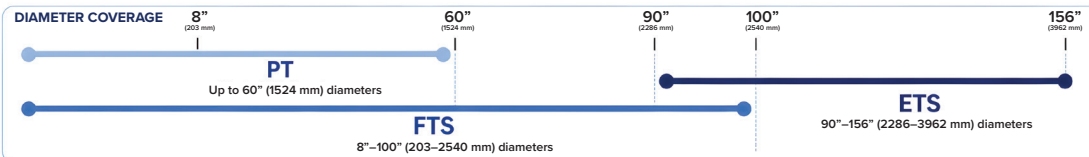

SKELECORE™ ADVANTAGES

- Minimal to no fabric deflation
- Cleaner, more stable appearance
- Engineered for reliable performance across a wide range of applications
- Enhanced long-term durability

It Starts with the Ring

SkeleCore begins by decoupling from metal ductwork.

Traditional fabric systems can transfer tension back to the metal outlet, increasing stress on seams, hangers, and connections.

SkeleCore uses an independent ring structure to support the fabric system without relying on the metal duct for tension.

